

## PARTS LIST AND INSTRUCTIONS FOR V-Speed DC Table Control

 **WARNING:** Improper installation, adjustment, alteration, service or maintenance can cause property damage, injury or death. Read the installation, operating and maintenance instructions thoroughly before installing or servicing this equipment.

L'installation déplacée, l'ajustement, le changement, le service ou l'entretien peuvent causer les dommages de propriété, la blessure ou la mort. Lire l'installation, fonctionnant et les instructions d'entretien à fond avant d'installer ou entretenir cet équipement.

La instalación impropia, ajuste, modificación, servicio o mantenimiento puede causar dañado propiedad, herida o muerte. Lea la instalación, trabajar y mantenimiento instrucciones completamente antes de instalar o poner en funcionamiento equipo.

### **DANGER !**



Shock hazard exists! Disconnect all power before opening enclosure for servicing. Allow 5 minutes power off for capacitor to discharge on circuit board. Control must be grounded.

Danger de choc existe! Débrancher tout pouvoir électrique avant d'ouvrir le couvercle. Permettre cinq minutes pour le condensateur pour décharger. Contrôle électronique doit avoir fil de terre.

Calambre peligro existe! Desconecte todo energia eléctrica de controlar antes de abrir la tapa. Permita cinco minutos para condensador de descargar antes de abrir. El control se debe moler.



**Note:** The original, authoritative version of this manual is the English version produced by CTB, Inc. or any of its subsidiaries or divisions, (hereafter collectively referred to as "CTB"). Subsequent changes to any manual made by any third party have not been reviewed nor authenticated by CTB. Such changes may include, but are not limited to, translation into languages other than English, and additions to or deletions from the original content. CTB disclaims responsibility for any and all damages, injuries, warranty claims and/or any other claims associated with such changes, inasmuch as such changes result in content that is different from the authoritative CTB-published English version of the manual. For current product installation and operation information, please contact the customer service and/or technical service departments of the appropriate CTB subsidiary or division. Should you observe any questionable content in any manual, please notify CTB immediately in writing to: CTB Legal Department, P.O. Box 2000, Milford, IN 46542-2000 USA.

V-SPEED CONTROL WIRING DIAGRAM

LID BOX

JUMPER WIRE

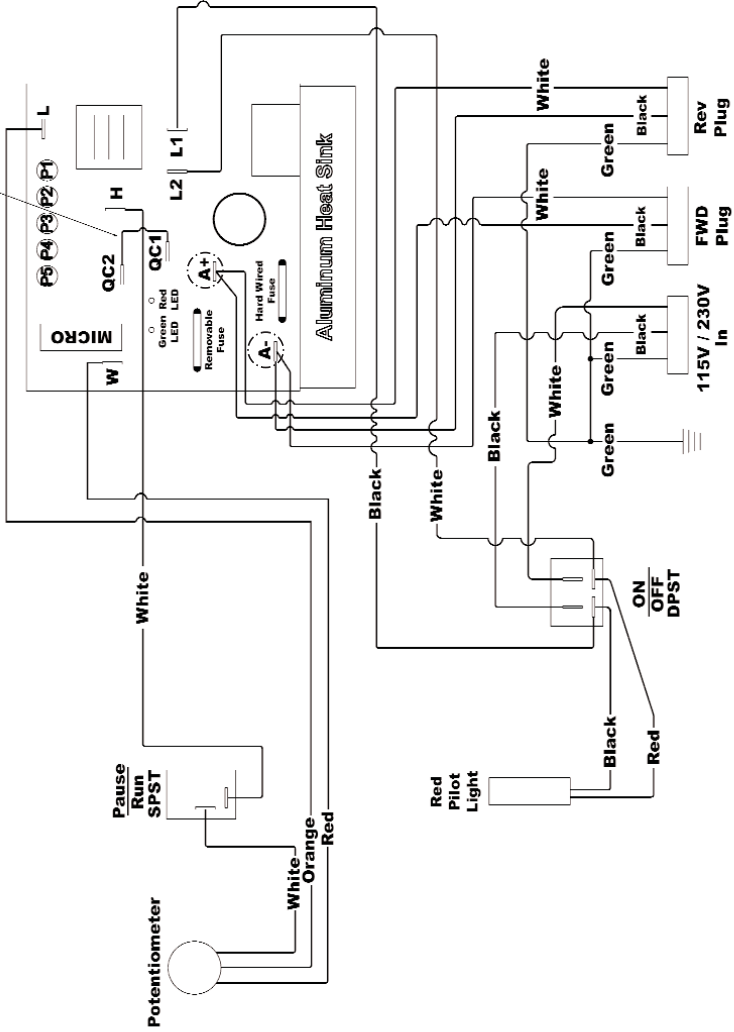

## Adjustment Procedure for the Gemini DC Variable Speed Control Board

### Model 12M04-00222 w/5M12-46 Chip (120V) or w/5M12-41 Chip (240V)

*ALL ADJUSTMENT MUST BE DONE WITH A FULL BELT SYSTEM OR SIMULATED LOAD ON THE MOTOR*

1. With the main power off, turn the Speed Control on the front of the control box counterclockwise until it stops. This will be the minimum speed setting. Open the control box. Attach probes to read Voltage between A+ and A- terminals as labeled on the board. Turn the main power switch ON. Adjust the MIN SPEED potentiometer (P1) on the circuit board so that the voltage is between 0 and 5 VDC.
2. Turn the main power OFF. Turn the speed control located on the front of the control box clockwise until it stops. This will be the maximum speed setting. Open the control box and attach the probe to read voltage between A+ and A- terminals. Turn the main power switch ON. Adjust the MAX SPEED potentiometer (P2) on the circuit board so that the voltage is between 112 and 116 VDC.
3. Adjust the I.R. COMP potentiometer (P3) on the circuit board to 1/4 travel from full counterclockwise. Turn the P3 Potentiometer slowly clockwise until you can hear the motor RPM oscillate, and then back off slightly from that point. If the belt stalls during normal operation, increase the P3 set point gradually by turning the P3 potentiometer clockwise. When properly adjusted, the motor will be able to hold speed with sudden increases in the loading without P3 set at full clockwise.
4. The ACCEL potentiometer (P4) an adjustment for belt starting acceleration. When set fully counterclockwise, it will operate with instant motor drive acceleration (rapid). With P4 turned fully clockwise, the motor accelerate the slowest. This can be set to the operator's preference, but ¼ turn from full counterclockwise is recommended..
5. Set the CURRENT LIMIT (P5) to fully clockwise and then back off slightly. The control current limit is set at 11 amps DC instantaneous when set at maximum and is predetermined by the components installed on the board.
6. The removable fuse is an 8 amp slow-blow type such as an MDA-8
7. The Green LED on the circuit board indicates Power ON.
8. The Red LED on the circuit board indicates CURRENT LIMIT is activated.

## TABLE CONTROL - Variable Speed DC

### COMPLETE ASSEMBLIES:

16500061 CONTROL, V-SPD 240VAC/90VDC  
 16500062 CONTROL, V-SPD 120VAC/90VDC



### COMPONENT PARTS

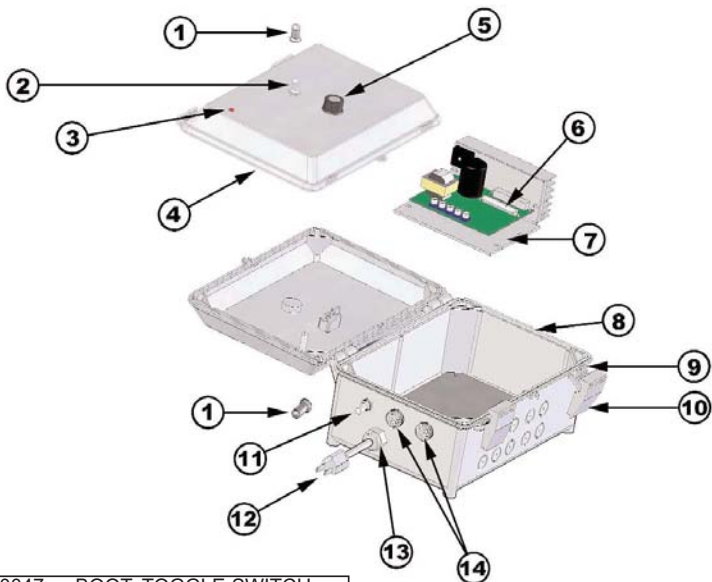

1	16000047	BOOT, TOGGLE SWITCH
2	13005282	SWITCH TOGGLE SING PO
3	15100589	PILOT LIGHT 250 VOLT
4	16500088	LID, V-SPEED CONTROL
5	16-101540	POTENTIOMETER: & KNOB
6	16000126	FUSE: 8 AMP SLOW BLOW (MDA-8)
7	16500065	BOARD,CRCT PRPROG 120VAC/90VDC
	16500064	BOARD,CRCT PRPROG 240VAC/90VDC

8	16500087	BOX: V-SPEED CONTROL
9	30863	PIVOT,CNTL BOX LATCH
10	30862	LATCH,CNTL BOX
11	13005283	SWITCH TOGGLE DOUBLE
12	16-10062	CORD: SJT-O W/PLUG 14/3
13	13008107	WIRE STRAIN RELIEF
14	16-101524	DISCONNECT: QUICK, FEMALE